

## Particular Specification

Item No:	BMS-306MAX
Weight:	7.1 grams / 0.26oz.
Size:	22 x 10 x 23 mm / 0.86 x 0.4 x 0.9 inch
Torque At 4.8V:	1.6kg/cm , 22 oz/in
Torque At 6.0V:	2.0 kg/cm , 25 oz/in
Speed At 4.8V:	0.13 sec / 60 deg at no load
Speed At 6.0V:	0.11 sec / 60 deg at no load
Ball Bearing:	Yes, Top of Single Ball Bearing
Gear Type:	FG(Fine Grain +15% M90)
Motor Type:	3 pole magnetic motor
Operating Voltage Range	3.6V ~ 6.0V
Operating Temperature Range	-20°C to +60°C
Idle Current	5mA at Stopped
Running Current	215mA
Stall Current	520mA
Dead Bend Width	6 usec
Direction	Re-clock wise / pulse traveling 1100 to 1800 usec
Horn Gear Spline	20 Segments (External diameter: 3.6mm)
Connector Wire Length	160mm (6.29in)
Connector Horsing	Universal connector
Wire Info	Brown Wire = Battery Negative Red Wire = Battery Positive Orange Wire = Signal

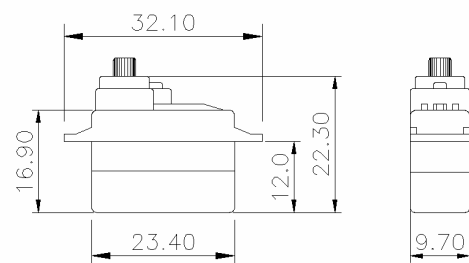

**Unit: mm**